

FLOORPLAN SKETCH

Borrower:	File No.: bo1216cuerto
Property Address: 1012 Cuerto Ln. A3	Case No.:
City: Fort Collins	State: CO
Lender: Agent: Wynn Washle	Zip: 80521

Scope of Work is on our website
www.appraisaldimensions.com
 12/22/2016
 (c) Copyright

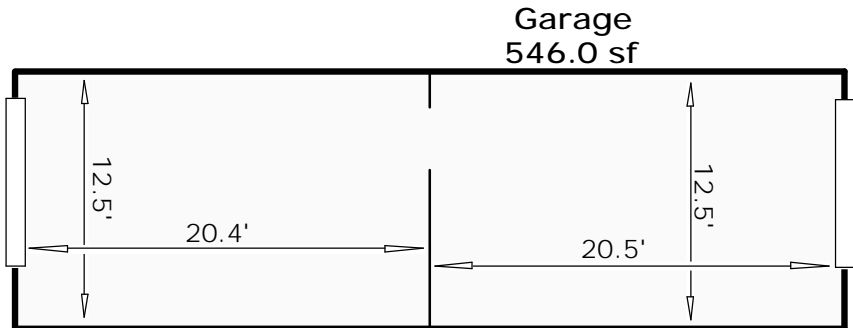

1012 Cuerto Ln. A3
 Total Sq Ft: 1548
 Total Finished Sq Ft: 1518
 Finished w/out bsmnt: 1010
 Basement Sq Ft: 538
 Basement Finish: 94%

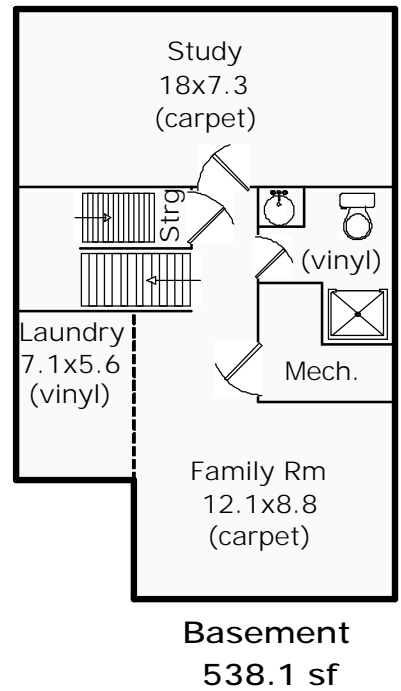
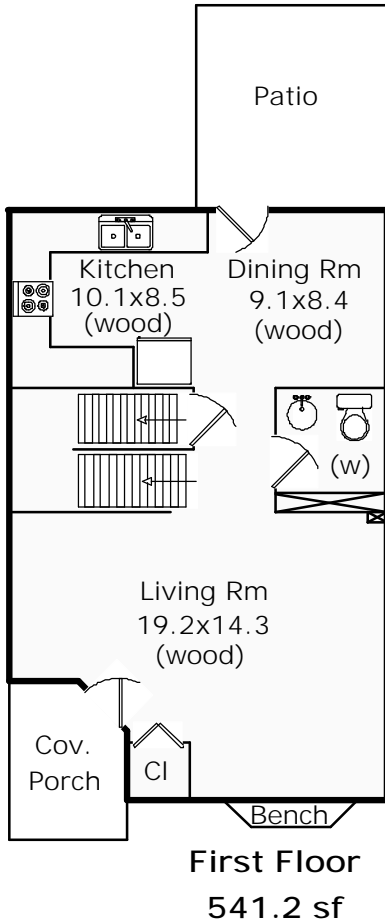
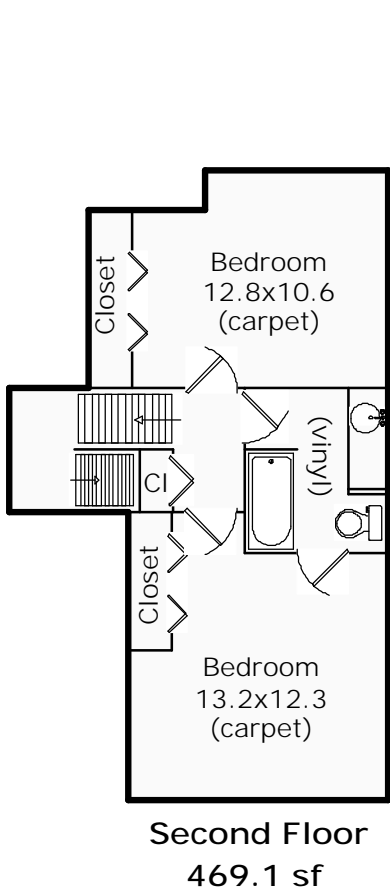

FLOORPLAN SKETCH

Borrower:	File No.: bo1216cuerto
Property Address: 1012 Cuerto Ln. A3	Case No.:
City: Fort Collins	State: CO Zip: 80521
Lender: Agent: Wynn Washle	

AREA CALCULATIONS SUMMARY			
Code	Description	Net Size	Net Totals
GLA1	First Floor	541.21	541.21
GLA2	Second Floor	469.08	469.08
BSMT	Basement	538.08	538.08
GAR	Garage	546.00	546.00
Net LIVABLE Area		(rounded)	1010

LIVING AREA BREAKDOWN			
Breakdown			Subtotals
First Floor			
13.2	x	6.0	79.20
23.9	x	19.2	458.88
0.5	x	2.5	3.13
Second Floor			
13.2	x	14.6	192.72
2.0	x	9.3	18.60
9.0	x	15.2	136.80
6.3	x	19.2	120.96
7 Items			(rounded) 1010

<p>First Floor</p> <p align="right">13.2 x 6.0 = 79.20</p> <p align="right">23.9 x 19.2 = 458.88</p> <p align="right">0.5 x 2.5 = 3.12</p>	<p align="center">GLA1</p>
---	-----------------------------------

Area total (rounded) = 541

<p align="right">13.2 x 6.0 = 79.20</p> <p align="right">23.9 x 19.2 = 458.88</p>	<p>Basement</p> <p align="center">BSMT</p>
---	--

Area total (rounded) = 538

<p align="right">13.2 x 14.6 = 192.72</p> <p align="right">2.0 x 9.3 = 18.60</p> <p align="right">9.0 x 15.2 = 136.80</p> <p align="right">6.3 x 19.2 = 120.96</p>	<p>Second Floor</p> <p align="center">GLA2</p>
--	--

Area total (rounded) = 469

<p align="right">13.0 x 42.0 = 546.00</p>	<p>Garage</p> <p align="center">GAR</p>
---	---

Area total (rounded) = 546