

2612 Kildeer Dr
Total SF All Lvl: 2002 sf
Total Finished SF: 1464 sf
Fin SF w/o Bsmnt: 1464 sf
Basement: 538 sf
Basement Finish: 0%

11/17/2016
 Agent: Wynn & Laura Jo Washle
 Scope of Work is on our website
 www.appraisaldimensions.com
 (C) Copyright

Upper Level
624.0 sf

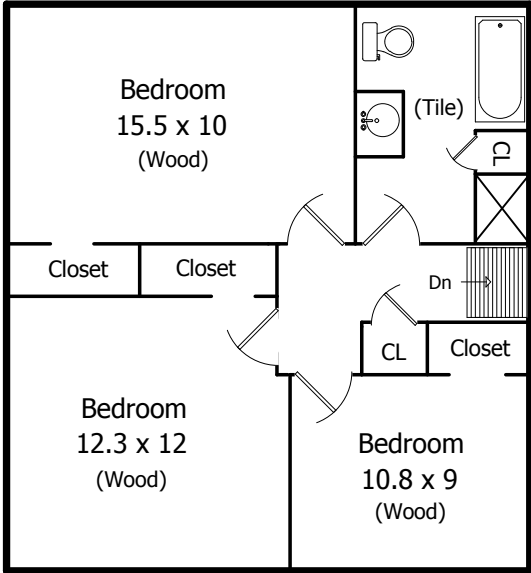

Basement
538.0 sf

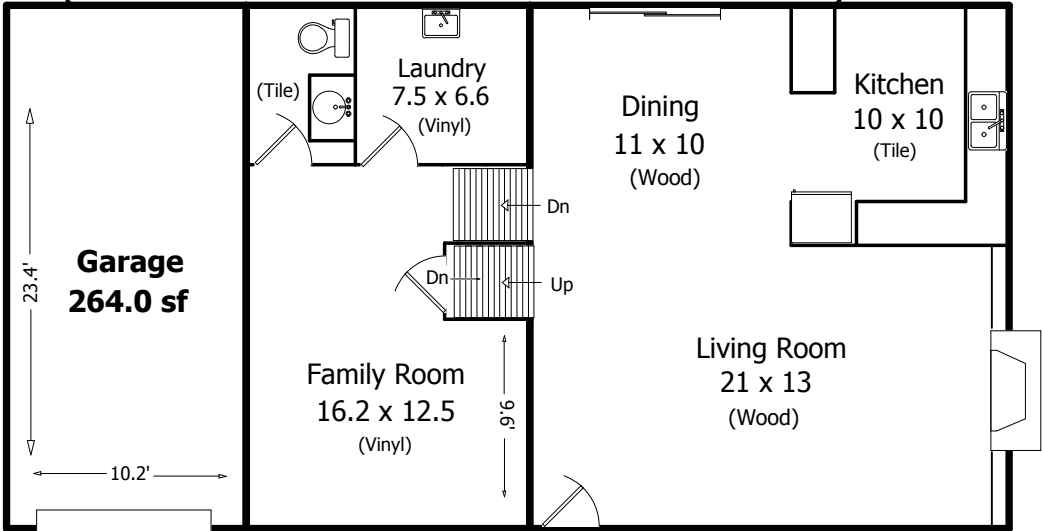
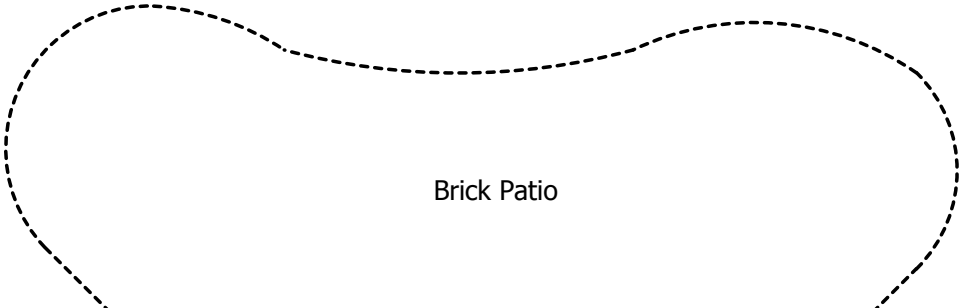
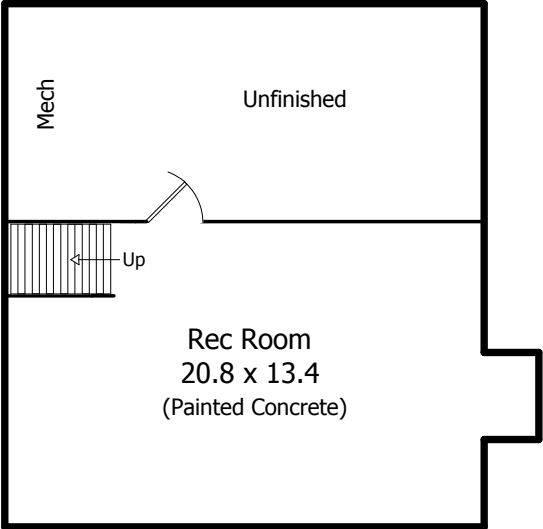

Lower Level
312.0 sf

Main Level
528.0 sf

