

FLOORPLAN SKETCH

Borrower: File No.: mk0415lynnhavenm  
 Property Address: 2549 Lynnhaven Ln Case No.:  
 City: Fort Collins State: CO Zip:  
 Lender: Wynn Washle

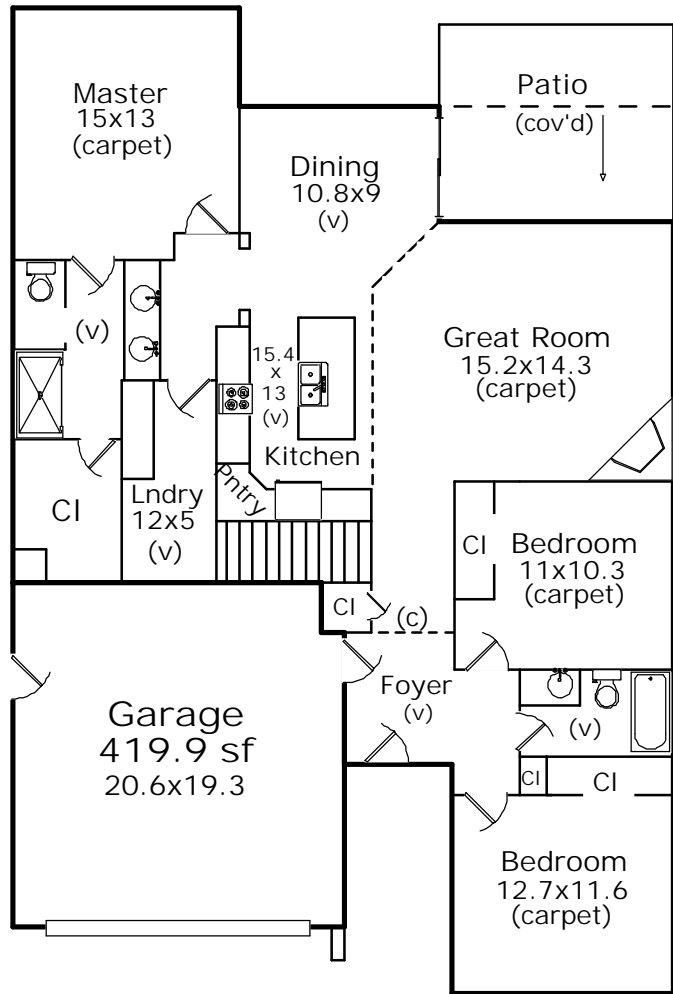

First Floor  
1562.5 sf

Basement  
1558.1 sf

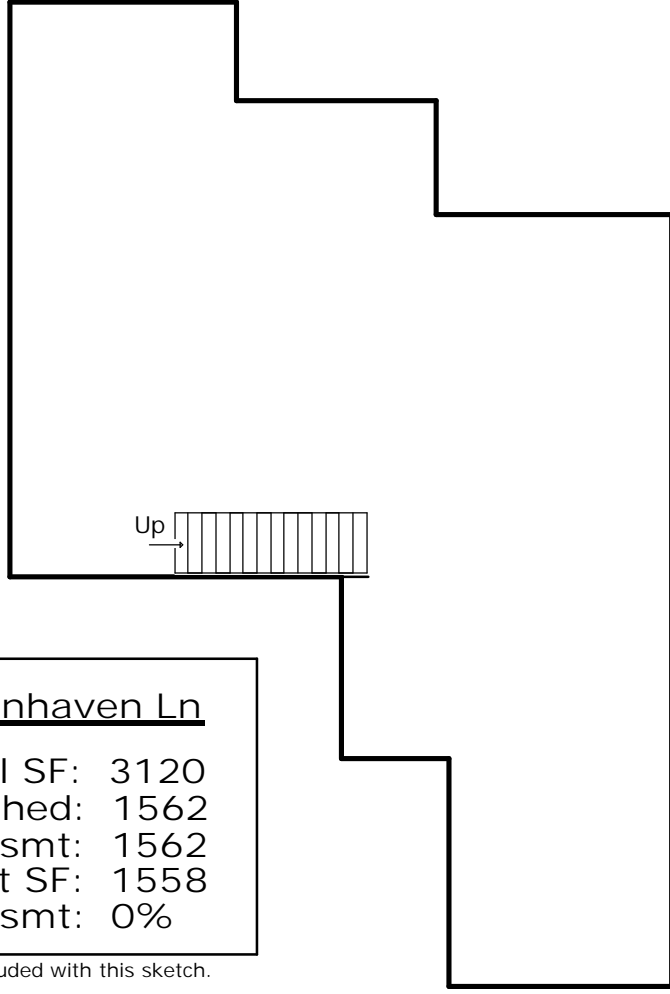

2549 Lynnhaven Ln  
 Total SF: 3120  
 Total Finished: 1562  
 Fin w/o Bsmt: 1562  
 Bsmt SF: 1558  
 Fn Bsmt: 0%

Scope of work is included with this sketch.

www.appraisaldimensions.com  
 Catherine T. Miles, CRA  
 Mary Kay Loner  
 April 1, 2015  
 (c)Copyright

FLOORPLAN SKETCH

|                                     |                            |
|-------------------------------------|----------------------------|
| Borrower:                           | File No.: mk0415lynnhavenm |
| Property Address: 2549 Lynnhaven Ln | Case No.:                  |
| City: Fort Collins                  | State: CO Zip:             |
| Lender: Wynn Washle                 |                            |

| AREA CALCULATIONS SUMMARY |             |           |            |
|---------------------------|-------------|-----------|------------|
| Code                      | Description | Net Size  | Net Totals |
| GLA1                      | First Floor | 1562.49   | 1562.49    |
| BSMT                      | Basement    | 1558.15   | 1558.15    |
| GAR                       | Garage      | 419.86    | 419.86     |
| Net LIVABLE Area          |             | (rounded) | 1562       |

| LIVING AREA BREAKDOWN |      |                |
|-----------------------|------|----------------|
| Breakdown             |      | Subtotals      |
| First Floor           |      |                |
| 13.8 x                | 6.0  | 82.80          |
| 25.9 x                | 7.0  | 181.30         |
| 40.2 x                | 22.0 | 884.40         |
| 13.9 x                | 13.5 | 187.65         |
| 8.0 x                 | 20.0 | 160.00         |
| 3.1 x                 | 21.4 | 66.34          |
| 6 Items               |      | (rounded) 1562 |

| Garage |      | GAR |        |
|--------|------|-----|--------|
| 18.8 x | 3.1  | =   | 58.28  |
| 20.2 x | 17.9 | =   | 361.58 |

| First Floor |      | GLA1 |        |
|-------------|------|------|--------|
| 13.8 x      | 6.0  | =    | 82.80  |
| 25.9 x      | 7.0  | =    | 181.30 |
| 40.2 x      | 22.0 | =    | 884.40 |
| 13.9 x      | 13.5 | =    | 187.65 |
| 8.0 x       | 20.0 | =    | 160.00 |
| 3.1 x       | 21.4 | =    | 66.34  |

Area total (rounded) = 420

Area total (rounded) = 1562

| Basement |      | BSMT |        |
|----------|------|------|--------|
| 6.0 x    | 13.8 | =    | 82.80  |
| 11.1 x   | 20.0 | =    | 222.00 |
| 22.0 x   | 40.2 | =    | 884.40 |
| 7.0 x    | 25.9 | =    | 181.30 |
| 13.9 x   | 13.5 | =    | 187.65 |

Area total (rounded) = 1558

April 1, 2015

Wynn Washle  
wwashle@thegroupinc.com

File Number: mk0415lynnhavenm

**SCOPE OF WORK:**

In accordance with your request, I have measured the following home and provided a sketch of the floor plan. Square footage is taken from outside measurements as per ANSI (American National Standards Institute) guidelines which are the guidelines to which HUD refers, with the exception of below grade finished areas. In this case we follow local custom which is to include the garden level in tri-levels in finished above grade square footage.

2549 Lynnhaven Ln  
Fort Collins, CO

Homes where outside measurement are inaccessable, inside measurements are used & an additional .5' is added for the outside wall. In rooms with sloping ceilings, the area measured is from where the ceiling is at least 5' high. Rms that are not square or rectangular, measurements are taken from the longest points. Attached dwellings are measured from the centerline between units where appropriate. Condos are measured from interior walls. Bdrms are measured excluding closets. Kitchens are measured wall to wall.

April 1, 2015

All totals are estimates based on exterior dimensions. It is not unusual for two different appraisers to arrive at slightly different totals.

Thank you for your business.

Mary Kay Loner  
Appraisal Dimensions  
970-227-1429