

FLOORPLAN SKETCH

Borrower: File No.: mk0213welizam  
Property Address: 3002 West Elizabeth St 24C Case No.:  
City: Fort Collins State: CO Zip:  
Lender: Wynn Washle

Total SF: 1147  
Total Finished: 1147  
Fin w/o Bsmt: 1147  
Bsmt SF: 0

Scope of work is included with this sketch.

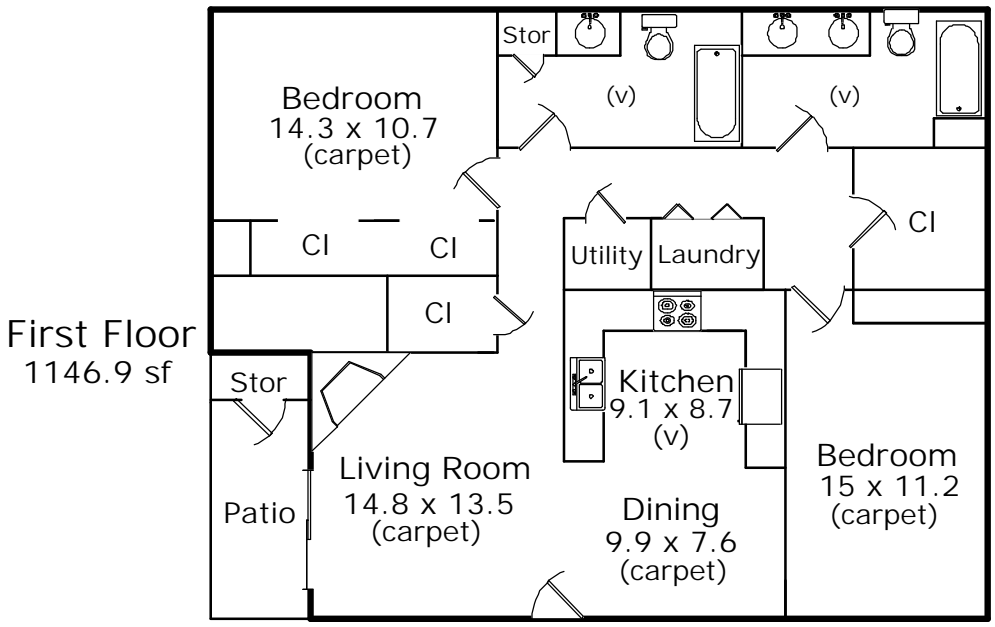

Appraisal Dimensions, LLC  
www.appraisaldimensions.com  
Catherine T. Miles, CRA  
Mary Kay Loner, RA

February 28, 2013

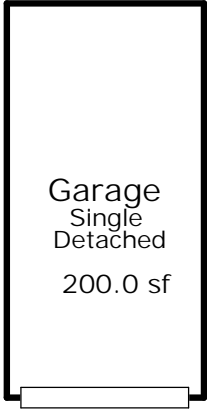

FLOORPLAN SKETCH

Borrower: \_\_\_\_\_ File No.: mk0213welizam  
 Property Address: 3002West Elizabeth St 24C Case No.: \_\_\_\_\_  
 City: Fort Collins State: CO Zip: \_\_\_\_\_  
 Lender: Wynn Washle

AREA CALCULATIONS SUMMARY			
Code	Description	Net Size	Net Totals
GLA1	First Floor	1146.87	1146.87
GAR	Garage	200.00	200.00
Net LIVABLE Area		(rounded)	1147

LIVING AREA BREAKDOWN				
Breakdown				Subtotals
First Floor				
0.5 x	0.0 x	17.4		0.00
	13.5 x	34.3		463.05
	39.3 x	17.4		683.82
0.5 x	13.5 x	0.0		0.00
4 Items				(rounded) 1147

First Floor		GLA1	
0.5 x	0.0 x	17.4 =	0.00
	13.5 x	34.3 =	463.05
	39.3 x	17.4 =	683.82
0.5 x	13.5 x	0.0 =	0.00

Garage		GAR	
10.0 x	20.0 =	200.00	

Area total (rounded) = 1147

Area total (rounded) = 200