

FLOORPLAN

Borrower:	File No.: b10213LaporteM
Property Address: 805 Laporte Ave	Case No.:
City: Fort Collins	State: CO
Lender: Agent: Wynn Washle	Zip: 80521

Total SF: 2098  
 Total Finished SF: 1901  
 Finished w/o Bsmnt: 1901  
 Basement SF: 197  
 Basement Finish: 0%

Scope of Work is defined and included with this sketch

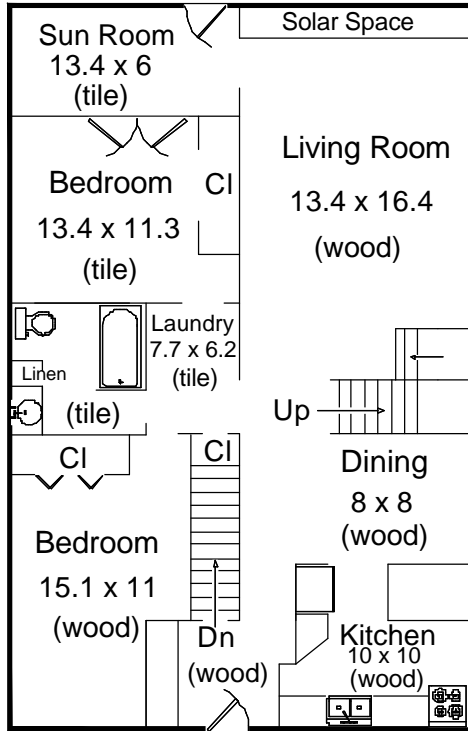

First Floor  
1232 SF

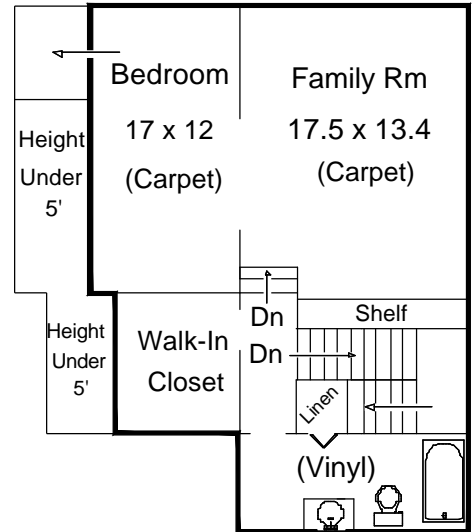

Second Floor  
669 SF

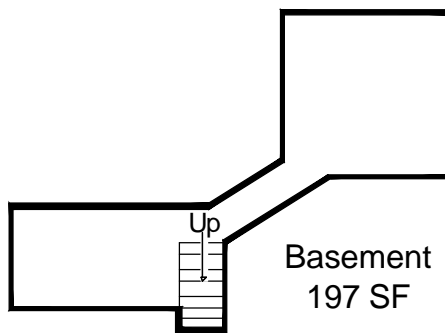

Basement  
197 SF

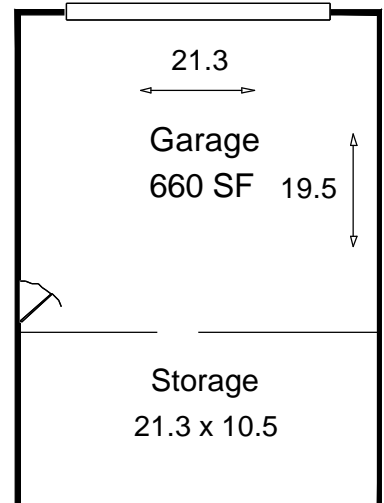

Garage Located To  
Rear of Property

Appraisal Dimensions, LLC  
 www.appraisaldimensions.com  
 Catherine T. Miles, CRA  
 Bob Loner  
 February 6, 2013

FLOORPLAN

Borrower:	File No.: bi0213LaporteM
Property Address: 805 Laporte Ave	Case No.:
City: Fort Collins	State: CO Zip: 80521
Lender: Agent: Wynn Washle	

AREA CALCULATIONS SUMMARY			
Code	Description	Net Size	Net Totals
GLA1	First Floor	1232.0	
	Second Floor	669.3	1901.3
BSMT	Basement	196.8	196.8
GAR	Garage	660.0	660.0
Net LIVABLE Area		(Rounded)	1901

LIVING AREA BREAKDOWN			
Breakdown			Subtotals
First Floor			
28.0	x	44.0	1232.0
Second Floor			
21.5	x	26.0	559.0
1.5	x	17.5	26.3
6.0	x	14.0	84.0
4 Items			(Rounded) 1901

First Floor	GLA1
28.0 x 44.0 =	1232.0
Area total (Rounded) = 1232	

Second Floor	GLA1
21.5 x 26.0 =	559.0
1.5 x 17.5 =	26.3
6.0 x 14.0 =	84.0
Area total (Rounded) = 669	

Basement	BSMT
7.2 x 10.0 =	72.0
2.8 x 5.3 =	14.8
4.0 x 10.2 =	40.8
0.5 x 1.0 x 0.6 =	0.3
0.5 x 4.1 x 2.6 =	5.3
0.0 x 2.6 =	0.1
0.5 x 1.0 x 0.7 =	0.3
0.7 x 3.1 =	2.0
0.2 x 4.1 =	0.8
0.5 x 0.7 x 0.5 =	0.2
0.5 x 0.6 x 0.4 =	0.1
0.5 x 2.3 x 1.5 =	1.7
0.5 x 2.0 x 1.3 =	1.2
0.5 x 1.7 x 1.1 =	0.9
0.5 x 1.4 x 0.9 =	0.6
0.5 x 1.2 x 0.8 =	0.4
0.5 x 1.9 x 2.9 =	2.7
0.5 x 1.0 x 1.6 =	0.8
2.2 x 12.0 =	26.4
1 unlisted calculations =	25.2
Area total (Rounded) = 197	

Garage	GAR
22.0 x 30.0 =	660.0
Area total (Rounded) = 660	

February 6, 2013

Agent: Wynn Washle  
Office: Mulberry

File Number: bI0213LaporteM

SCOPE OF WORK:

In accordance with your request, I have measured the following home and provided a sketch of the floor plan. Square footage is taken from outside measurements as per ANSI (American National Standards Institute) guidelines which are the guidelines to which HUD refers, with the exception of below grade finished areas. In this case we follow local custom which is to include the garden level in tri-levels in finished above grade square footage.

805 Laporte Ave  
Fort Collins, CO 80521

Homes where outside measurements are inaccessible, inside measurements are used & an additional .5' is added for the outside wall. In rooms with sloping ceilings, the area measured is from where the ceiling is at least 5' high. Rms that are not square or rectangular, measurements are taken from the longest points in most cases. Attached dwellings are measured from the centerline between units where appropriate. Condos are measured from interior walls. Bedrooms are measured excluding closets. Kitchens are measured wall to wall & include the nook if applicable.

February 6, 2013

All totals are estimates based on exterior dimensions. It is not unusual for 2 different appraisers to arrive at slightly different totals.

Bob Loner  
Appraisal Dimensions, LLC  
970-231-2222 (Cell) 866-332-0043 (Fax)

THANK YOU FOR YOUR BUSINESS