

FLOORPLAN

Borrower: File No.: mk1012goodwinm  
 Property Address: 3673 Goodwin St Case No.:  
 City: Johnstown State: CO Zip:  
 Lender: Agent: Wynn Washle

Total SF: 4229  
 Total Finished: 2926  
 Fin.SF w/o Bsmt: 2888  
 Bsmt SF: 1341  
 Fin. Bsmt: 3%

\*Scope of work is defined and included with this sketch

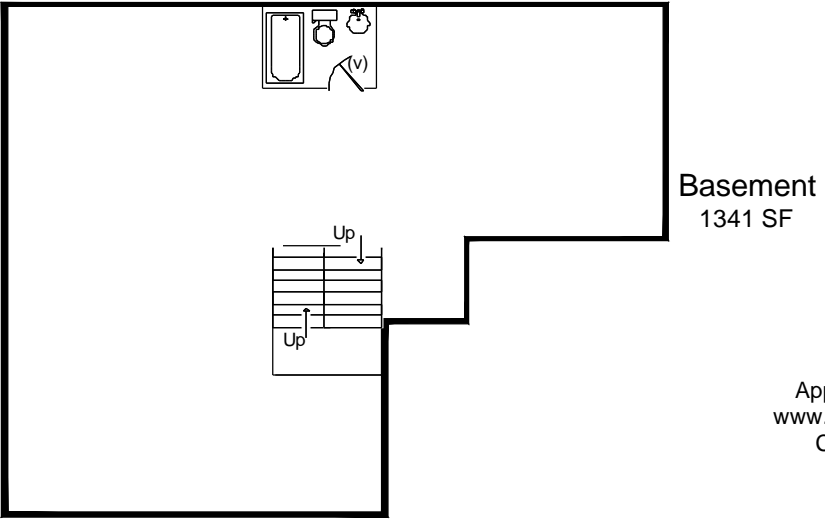
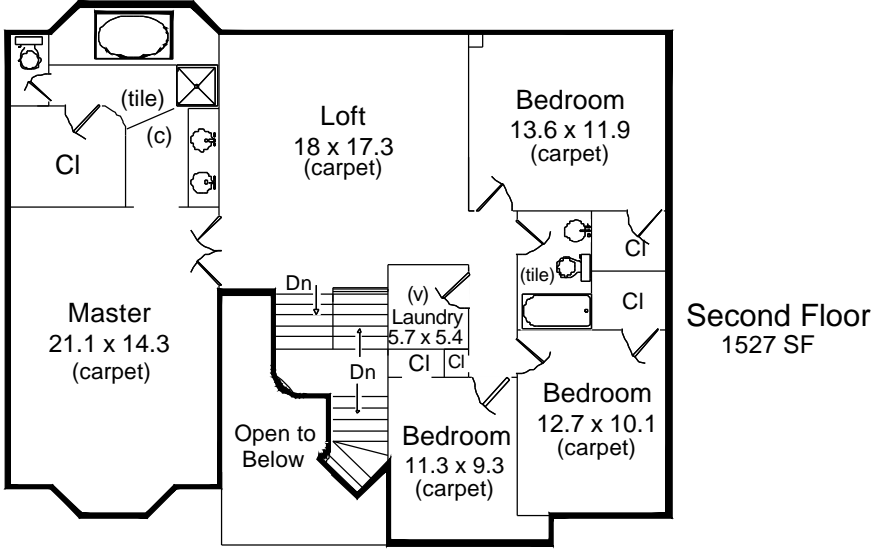
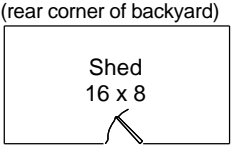
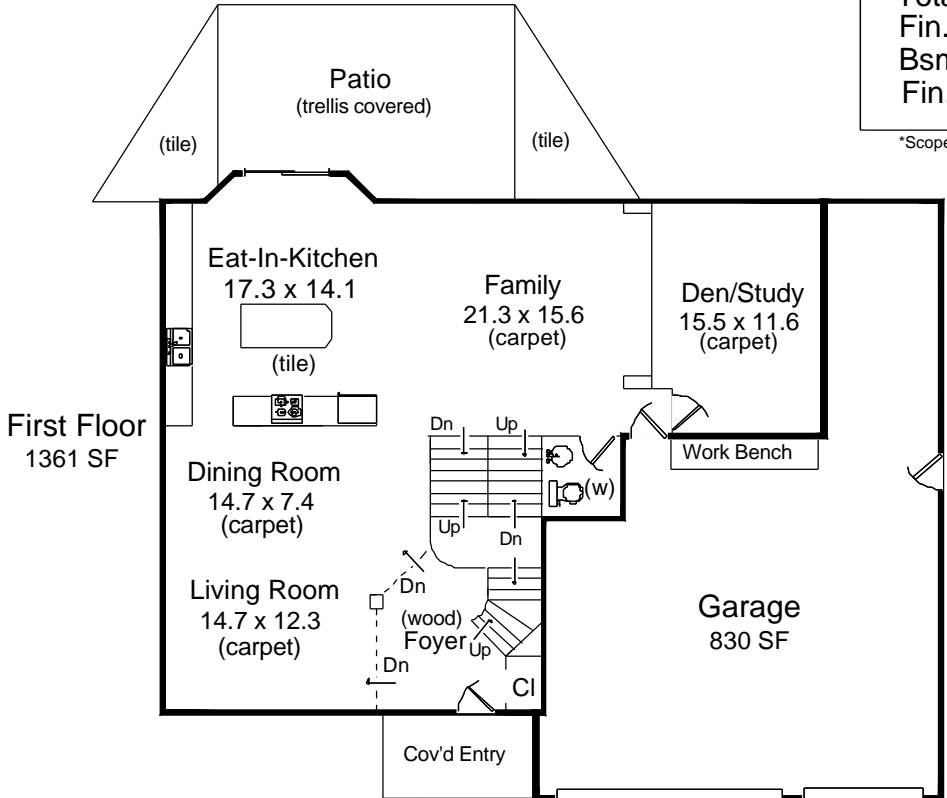

Appraisal Dimensions, LLC  
 www.appraisaldimensions.com  
 Catherine T. Miles, CRA  
 Mary Kay Loner, RA  
 October 28, 2012

FLOORPLAN

Borrower:	File No.: mk1012goodwinm
Property Address: 3673 Goodwin St	Case No.:
City: Johnstown	State: CO Zip:
Lender: Agent: Wynn Washle	

AREA CALCULATIONS SUMMARY			
Code	Description	Net Size	Net Totals
GLA1	First Floor	1361.0	1361.0
GLA2	Second Floor	1527.5	1527.5
BSMT	Basement	1340.8	1340.8
GAR	Garage	829.6	829.6
Net LIVABLE Area		(Rounded)	2888

LIVING AREA BREAKDOWN			
Breakdown			Subtotals
<b>First Floor</b>			
	16.6 x	43.9	728.7
	5.8 x	29.7	172.3
	2.0 x	8.1	16.2
0.5 x	2.0 x	2.0	2.0
0.5 x	2.0 x	2.0	2.0
	13.8 x	24.0	331.2
	3.0 x	36.2	108.6
<b>Second Floor</b>			
0.5 x	0.1 x	3.9	0.1
	5.6 x	11.5	64.4
	1.3 x	11.5	14.9
0.5 x	1.3 x	1.3	0.8
0.5 x	2.1 x	2.1	2.1
	1.8 x	2.1	3.8
	4.9 x	8.4	41.2
0.5 x	2.2 x	2.2	2.4
	2.2 x	25.9	57.0
	23.6 x	28.1	663.2
	3.5 x	24.1	84.3
	3.7 x	18.4	68.1
	1.1 x	3.9	4.1
	8.7 x	32.2	280.1
11 Items Not Listed			240.8
32 Items			(Rounded) 2888

First Floor		GLA1	
	16.6 x	43.9 =	728.7
	5.8 x	29.7 =	172.3
	2.0 x	8.1 =	16.2
0.5 x	2.0 x	2.0 =	2.0
0.5 x	2.0 x	2.0 =	2.0
	13.8 x	24.0 =	331.2
	3.0 x	36.2 =	108.6
Area total (Rounded) = 1361			

Garage		GAR	
	22.5 x	25.6 =	576.0
	5.7 x	19.8 =	112.9
	8.3 x	16.6 =	137.8
	0.5 x	6.0 =	3.0
Area total (Rounded) = 830			

Basement		BSMT	
	22.4 x	32.7 =	732.5
	13.8 x	27.0 =	372.6
	14.2 x	16.6 =	235.7
Area total (Rounded) = 1341			

Second Floor		GLA2	
0.5 x	0.1 x	3.9 =	0.1
	5.6 x	11.5 =	64.4
	1.3 x	11.5 =	14.9
0.5 x	1.3 x	1.3 =	0.8
0.5 x	2.1 x	2.1 =	2.1
	1.8 x	2.1 =	3.8
	4.9 x	8.4 =	41.2
0.5 x	2.2 x	2.2 =	2.4
	2.2 x	25.9 =	57.0
	23.6 x	28.1 =	663.2
	3.5 x	24.1 =	84.4
	3.7 x	18.4 =	68.1
	1.1 x	3.9 =	4.1
	8.7 x	32.2 =	280.1
	2.0 x	4.7 =	9.4
0.5 x	2.0 x	2.0 =	2.0
0.5 x	2.0 x	2.0 =	2.0
	3.2 x	32.2 =	103.0
	3.2 x	32.2 =	103.0
6 unlisted calculations =			21.4
Area total (Rounded) = 1527			